

Audo

COPENHAGEN



ANDROGYNE SIDE TABLE, Ø40
Designed by *Danielle Siggerud*



ANDROGYNE SIDE TABLE, Ø40
Designed by *Danielle Siggerud*

Perfectly proportioned, the Androgyne Side Table balances a rounded marble tabletop on a powder coated or brushed steel base that features wide, flat legs, laser-cut for precision. The architect-designed piece is offered in a number of materials that can be co-ordinated or contrasted as desired. The latest addition to the collection is a tabletop in Emperador marble, a richly veined marble with intense brown tones, as well as calcatta viola, already known from the Plinth Collection. Carefully selected for its inherent beauty and light-reflecting qualities, the different marble tops provide a top provides a tactile and natural contrast to the sleek metal.

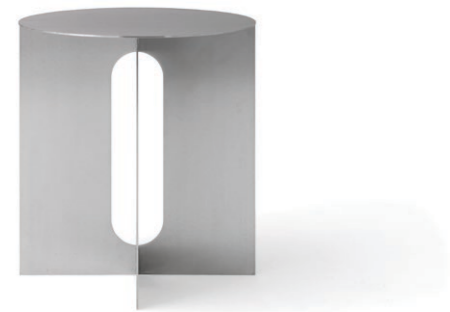

PRODUCT OPTIONS

Tabletop



CRYSTAL ROSE MARBLE

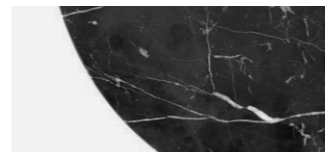

NERO MARQUINA MARBLE

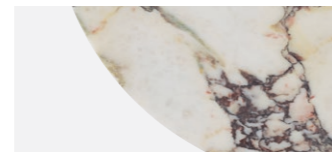

CALACATTA VIOLA MARBLE

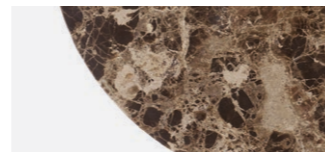

EMPERADOR MARBLE

Powder coated steel base



CRYSTAL ROSE MARBLE

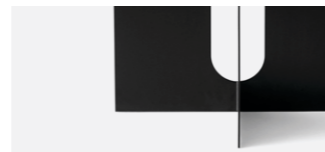

BLACK STEEL



BRUSHED STEEL

PRODUCT TYPE
Side table

COLLI
1

ENVIRONMENT
Indoor

DIMENSIONS

Steel base
H: 43 cm / 16,9"
Ø: 40 cm / 15,7"

Steel base with marble top
H: 44,8 cm / 17,6"
Ø: 42 cm / 16,5"

PRODUCTION PROCESS
Welded CNC-cut steel sheet with powder coated finish. The table top are CNC milled and treated with a sealer.

TECHNICAL SPECIFICATIONS

COLOUR

Marble top
Crystal Rose
Nero Marquina
Calacatta Viola
Emperador

Base
Black (RAL 9005)
Ivory (NCS S 1002-Y50R)

MATERIALS

Powder coated or brushed steel and Crystal Rose marble, Nero Marquina marble, Calacatta viola marble or Emperador marble.

GLOSS
Gloss 5-10

WEIGHT
Marble top: 6,9 kg / 15,2 lb
Steel base: 9,7 kg / 21,4 lb

TEST
N / A

CERTIFICATIONS
N / A

PACKAGING TYPE
Gift box

PACKAGING MEASUREMENTS
(H × W × D)

Marble top
16 cm × 49,5 cm × 49,5 cm /
6,3" × 19,5" × 19,5"

Steel base
49 cm × 43 cm × 43 cm /
19,3" × 16,9" × 16,9"

MATERIALS & MAINTENANCE
Please visit audocph.com for materials, care and maintenance instructions.

STEEL BASE

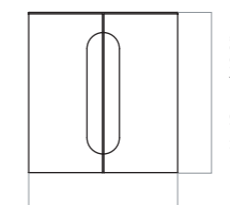
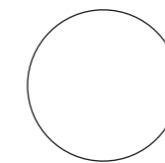

Ø: 40 cm / 15,75"

STEEL BASE WITH MARBLE TABLETOP

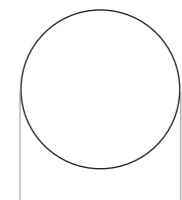

Ø: 42 cm / 16,5"

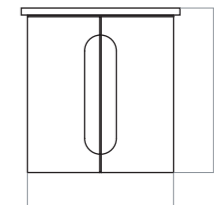

Ø: 40 cm / 15,75"